

balcony

- Spacious and private
- Breathtaking view of the Gulf of Mexico

living/dining room

- Open living and dining area
- South facing view
- 9 foot ceilings (approximate)
- Carpeted
- 8 foot sliding glass door

kitchen

- Granite countertops
- Breakfast bar
- Raised panel cabinets
- Ceramic tile floor
- GE Profile™ or equivalent:
 - Refrigerator with ice maker
 - Self cleaning oven/range
 - Dishwasher
 - Built-in microwave

bedroom

- 9 foot ceilings (approximate)
- Carpeted
- Window overlooking the north balcony
- Adjoining bath with ceramic tile

Gross heated & cooled 732 sqft
 Gross balcony 169 sqft
 Total 901 sqft

Net heated & cooled 683 sqft
 Balcony 136 sqft
 Total 819 sqft

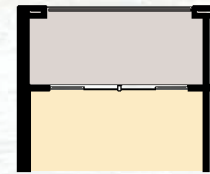
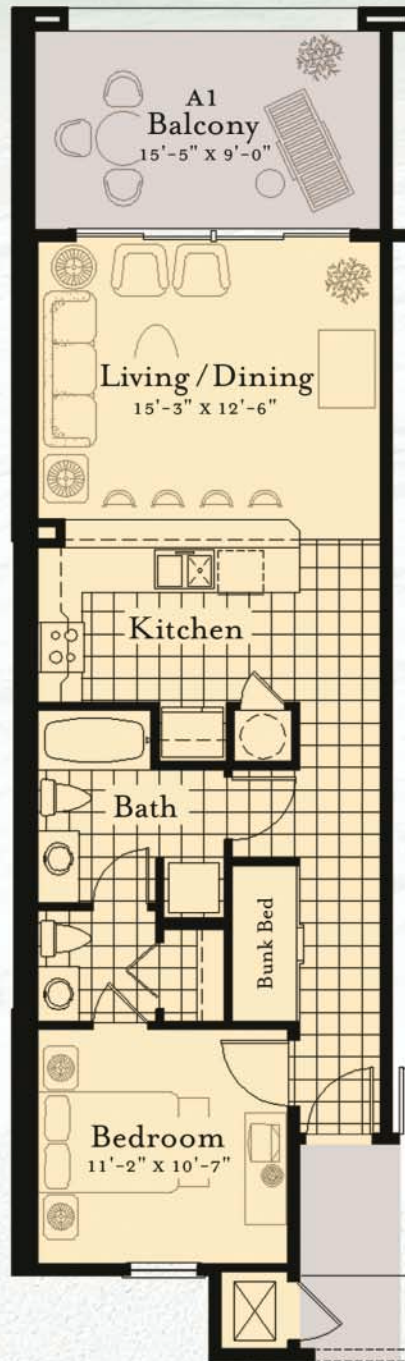

A2 BALCONY

Gross heated & cooled 732 sqft
 Gross balcony 154 sqft
 Total 886 sqft

Net heated & cooled 683 sqft
 Balcony 145 sqft
 Total 828 sqft

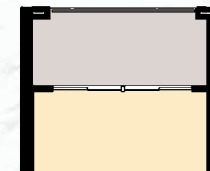

A3 BALCONY

Gross heated & cooled 732 sqft
 Gross balcony 123 sqft
 Total 855 sqft

Net heated & cooled 683 sqft
 Balcony 105 sqft
 Total 788 sqft

Ariel
 DUNES



All square footages are approximate.
 Developer reserves the right to make any modifications as it deems necessary.